

EPG 2814

This box contains:
Aluminum Profile - 2500mm
Diffuser - 2500mm
End caps - 4 pieces

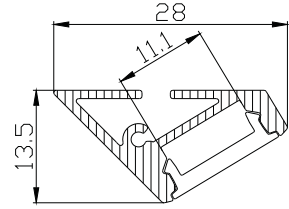

Installation instructions



"Prior to installation, choose a location for the power supply and make sure that it is connected to the light switcher."

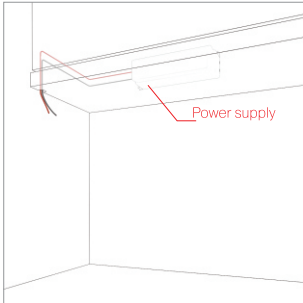

1 | Make the electrical connection to the power supply and then run the wires to the location of the light fixture.

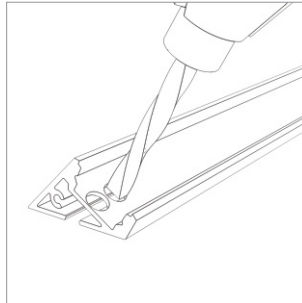

2 | Drill a hole into the fixture for low voltage wires.

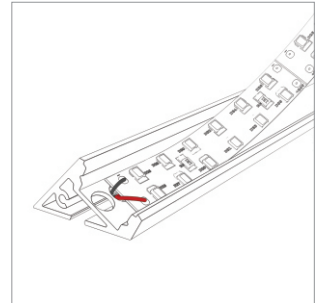

3 | Install the LED strip on the fixture surface.

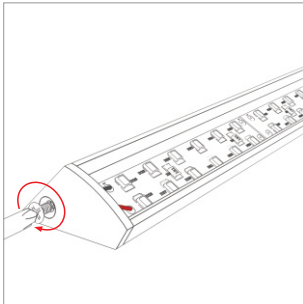

4 | Secure the end caps.

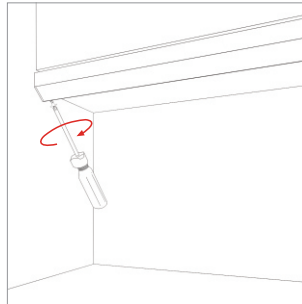

5 | Connect the wires and secure the fixture into the surface.

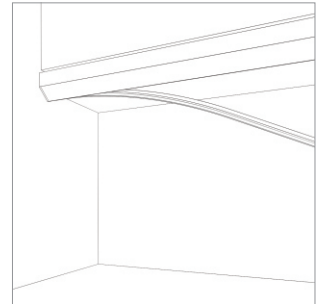

6 | Install the diffuser.

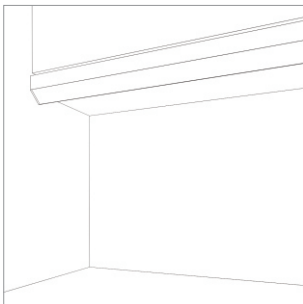

7 | The fixture is ready for use.
Enjoy the light!